

These particulars have been prepared as accurately and as reliably as possible, but should not be relied upon as 'statement of fact'. If there is any point which is of particular importance to you, please contact the office and we would be pleased to check the information. We have not tested any services, appliances, equipment or facilities and nothing in these particulars should be deemed to be a statement that they are in good working order, or that the property is in good structural condition or otherwise. Any areas, measurements, floor plans or distances referred to are given as a guide only and are not precise. Purchasers must satisfy themselves by inspection or by otherwise regarding the items mentioned above and as to the correctness of each of the statements contained in these particulars. No person in the employment of Ashtons has any authority to make or give any representation or warranty whatsoever in relation to this property or these particulars nor enter into any contract relating to the property on behalf of the vendor. Please note that some images may have been edited with the use of AI. We are legally required to carry out AML checks for all purchasers, sellers and giftors, which become mandatory once an offer has been accepted. There is a non-refundable fee of £30 + VAT per purchaser and per giftor for these checks.

- Attractive Period Terrace Property
- Front Forecourted
- Two Double Bedrooms
- A Short Walk To Bishopthorpe Road
- Well Maintained
- No Onward Chain
- On Street Parking
- EPC - D

Freehold  
Council Tax Band - B

# Balmoral Terrace , York YO23 1HS

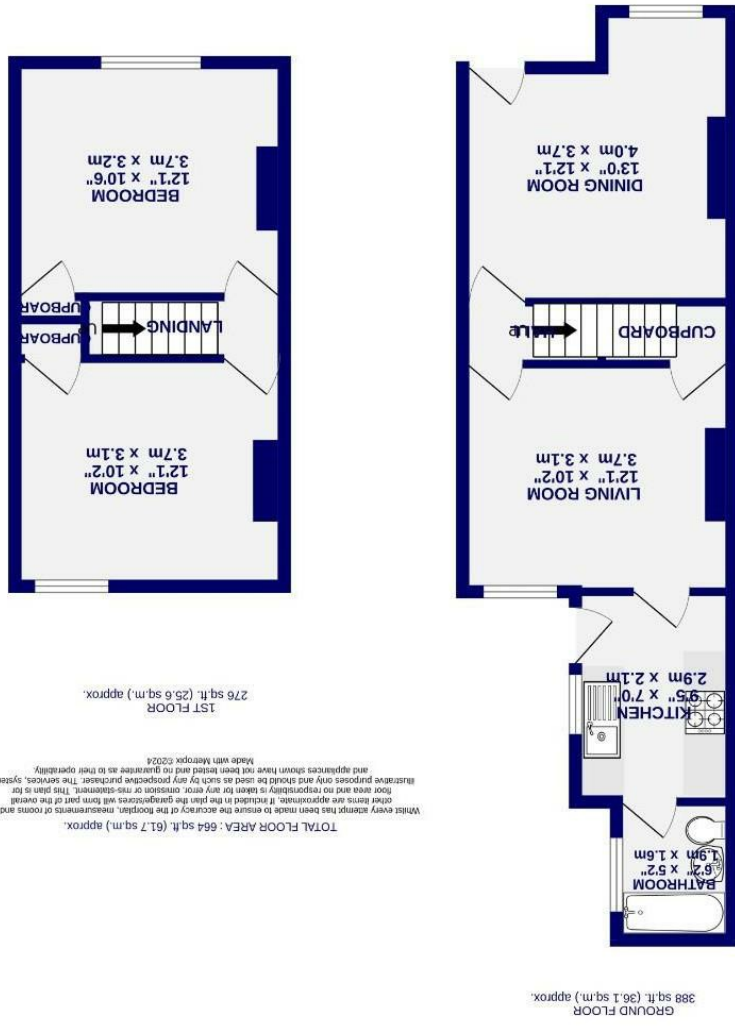

# Balmoral Terrace

, York

YO23 1HS

£280,000

🛏️ 2 🚿 1

This pretty period terraced property is set to the South of York, within walking distance of the city centre, well placed for varied commuter links and just a short stroll from Bishopthorpe Road and the many much acclaimed amenities the area has to offer.

Previously a successful rental property and sure to appeal to a range of potential buyers, the accommodation is flexible and spacious and is ready to move in to yet also offers scope for the next owner to add their own taste or adapt to suit their needs.

To the ground floor are two good sized reception rooms with kitchen beyond boasting a range of units and appliances. The bathroom is fitted with a white suite and there are two double bedrooms to the first floor.

Externally, there is an enclosed courtyard style garden and on street parking is available.

Council Tax Band: B

